

FHA 5038 SH

Model number:

141478

Dimensions: 51" x 39" x 79"

Installation: Alcove

Material: AcrylX™



Standard Features:

- Available in the Midwest
- One-piece AcrylX™ shower
- Constructed to comply with the guidelines of the Fair Housing Act Design Manual
- Center drain
- Textured bottom
- Low 3 1/2" threshold for safe in and out access

Product characteristics:

- One-Piece Unit
- Integrated Shelving
- Low Threshold

Warranty:

Lifetime limited

Code Compliant:

FHA|ANSIB

Standard colors:



White (002)



Bone (004)



Biscuit (007)

Certifications

ABG products adhere to one or more of the following certifications:



Options (Visit our website for a complete list of our options)

No	Description
<input type="checkbox"/> OPT 20213	36 in. Modern horizontal straight grab bar on back wall
<input type="checkbox"/> OPT 20257	48" curtain rod
<input type="checkbox"/> OPT 20059-084	Recessed soap dish (Drilled, not installed) in chrome
<input type="checkbox"/> OPT 20203-VL	18" Modern straight vertical grab bar on left wall(factory installed)
<input type="checkbox"/> OPT 20203-VR	18" Modern straight vertical grab bar on right wall(factory installed)

FHA 5038 SH

Model number:

141478

Dimensions: 51" x 39" x 79"

Installation: Alcove

Material: AcrylX™

BASE MODEL

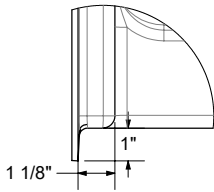
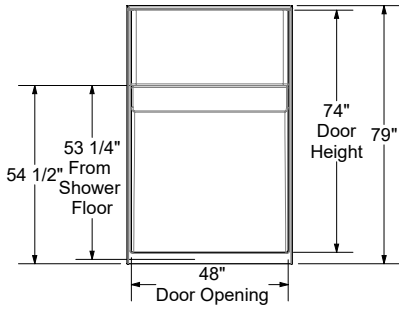
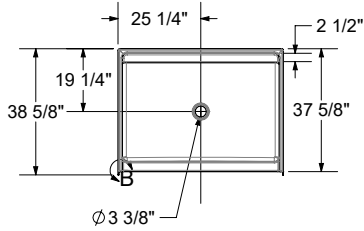

- All dimensions are approximate
- Structure measurements must be verified against the unit to ensure proper fit
- Installation to be completed in accordance with manufacturers specifications
- Do not scale drawings

STANDARD REINFORCEMENT BACKING



SEAT OPTIONAL REINFORCEMENT BACKING

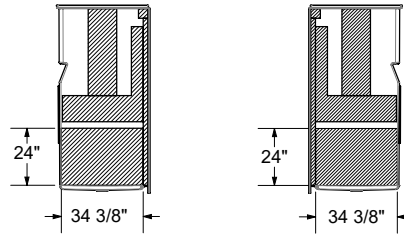

THRESHOLD DETAIL

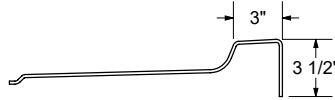

Dimensions:

50 5/8 x 38 5/8 x 79 in.

Weight:

122 lbs -

Shape:

Rectangular

Pieces:

1

Drain location:

No seat, center drain

Project:

Contractor:

Representative:

Date:

Tel:

Notes: